

GENOA WALL PANEL SYSTEM ALUMINIUM

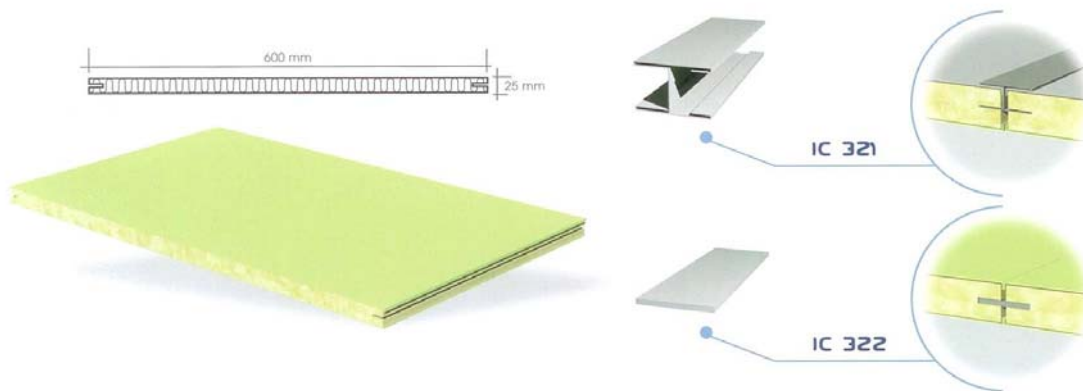

General Information	
description	aluminium partition panel with hidden joint
type	ItalCabin GX L6
manufacturer	Precetti S.p.A.
Application	
fire properties	all materials having low flame spread and non-combustible certificates
Size	
width	600 mm (max 920 mm) + toll.
length	up to 2500 mm + toll.
thickness of panel	25 mm
Structure	
core	150 Kg/m ³ rockwool
skins	aluminium
thickness of skins	1 mm
finishing	paint, PVC
Accessories	
standard	bottom profiles, top profiles, joint profiles, wall profiles
Mechanical and physical properties	
panel weight	n.a.
noise reduction	n.a.

Product data sheet

panel_GX_type_L6_rev00

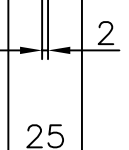
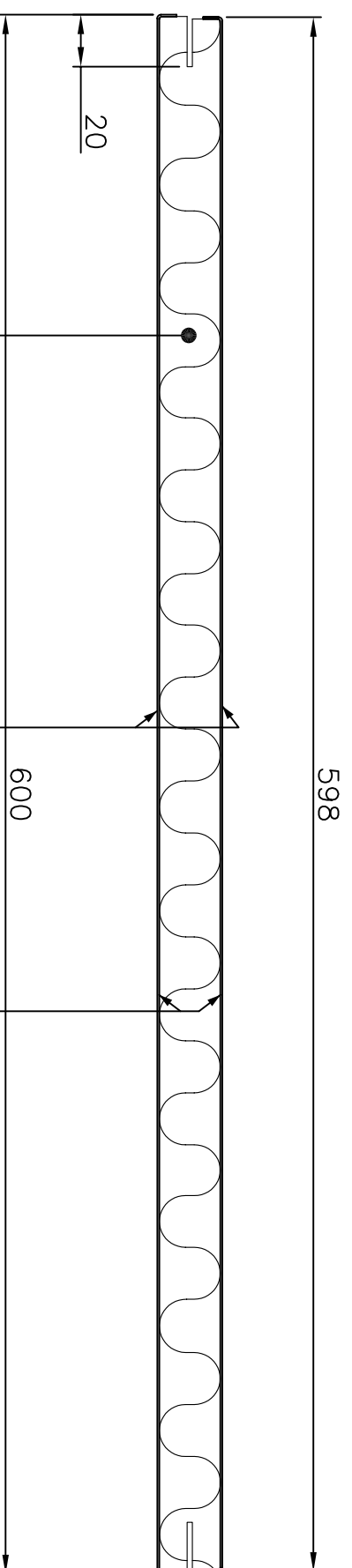
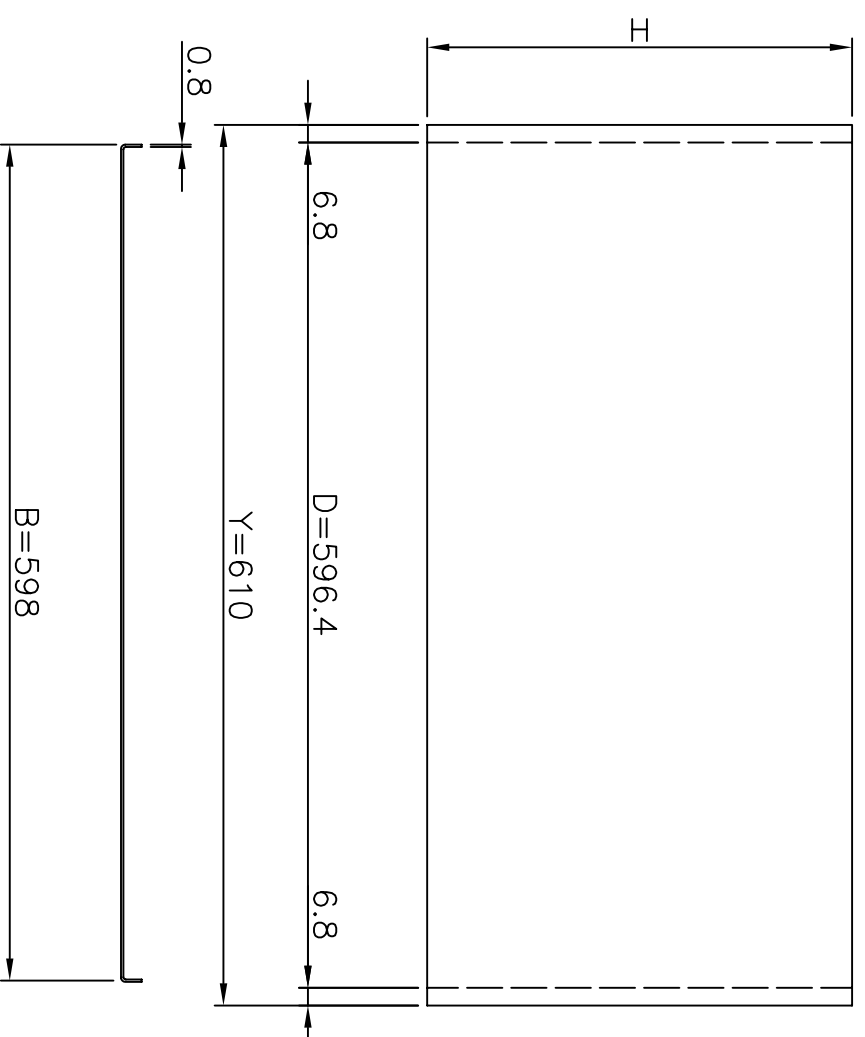
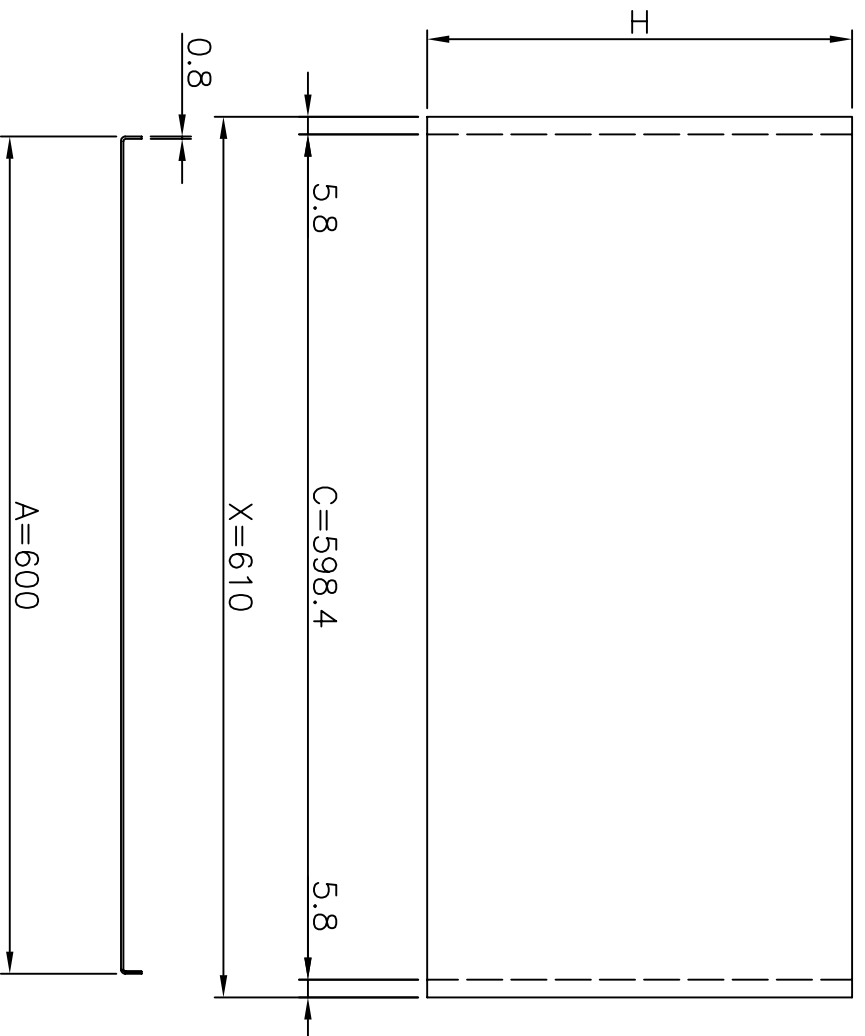

③	POLYURETHANE GLUE
②	ALUMINIUM COIL th. 08/10 H. 610 mm
①	ROCK WOOL PANEL 596X2200X23, 3 mm
N.	DESCRIZIONE DEL DETTAGLIO / DESCRIPTION OF DETAILS
Riferimento	SANDWICH PANELS
Descrizione	ALUMINIUM LINING type GX - L 6

Material Spessore - 25 mm Note Notes - n.a. Tolleranza generale General tolerance Width 1 mm - Height 2 mm Thickness 1 mm		BLUBUD srl Sede operativa: Via Dante 2/7 16121 Genova Italy Tel. +39-010.89.95.535/536 Fax. +39-010.89.95.537 Sede legale: Via Fieschi 20/9 16121 Genova Italy e-mail: info@blubud.it www: http://www.blubud.it		Scale 1:2.5 Controllato da Checked by - Classe prodotto Fire Rating - N. disegno Drawing IC101/AL	Data 17/06/2011 Disegnato da Drawn by -
---	--	--	--	--	--

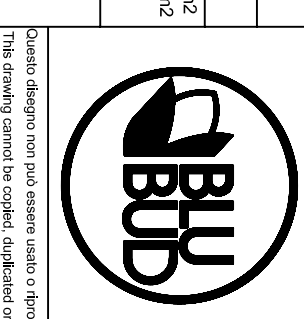

Questo disegno non può essere usato o riprodotto senza nostra autorizzazione
 This drawing cannot be copied, duplicated or disclosed without our permission